INSTALLATION OF P2000 AS GLUED PARQUET

Parklex 2000 is natural wood floating parquet with special characteristics that make it noticeably different from the rest of the parquets found on the market.

The glued parquet system is recommended for wood strips >188mm wide, or when it is mandatory for the slenderness of the piece (length / width) to be less than or equal to five.

GENERAL INSTALLATION INSTRUCTIONS

Calculating the material

To calculate the material necessary when placing the order, measure the installation surface in terms of square meters, increasing the result by 5% to account for cutting and loss. This percentage may vary slightly according to the layout of the surface to be installed.

Recommendations for handling

It is recommended not to open packages of parquet strips until the day before installation, as they may absorb moisture and expand, making it more difficult to fit the tongue and groove pieces together.

Before laying the floor, you must ensure that the material has a temperature of at least 18 °C. Check to see that the parquet strips and their edges are free of foreign bodies that may damage the material or make them more difficult to handle. Prevent the parquet strips from sliding over one another by lifting them, never dragging them.

Floor conditions prior to installation

The floor must meet certain minimum requirements before beginning to lay the material:

- It must be solid and even, with no risk of later deformations.
- It must have a humidity of less than 2.5% (less than 2% with in-floor radiant heating).
- It must be free of residue or other materials.
- It must be perfectly flat and smooth.

To get the floor to meet the above conditions, we may condition it in one of two ways:

By means of screeding, using perfectly levelled mortar with a minimum thickness of 4 cm.

By means of using battens installed at a distance of approximately 40 cm from each other, laying particle board on top of them. This should be preferably waterproof, and 16 or 19mm thick, maintaining peripheral separations of 6mm between the boards, allowing for their expansion.

Area conditions

The temperature of the area and the material must be at least 18°C.

During the installation, the area must have a degree of humidity of approximately 60%.

Selecting the direction of the parquet strips

Installation is recommended in the room's longitudinal direction, since the strip experiences less longitudinal movements than transversal movements.

This is especially important in large, narrow spaces, so that the parquet strips lie flat on the floor subsurface.

When using the glued system, the direction of the installation is not important, since the glue reduces the movement of the parquet strips.

Construction joints, expansion joints

Due to the effect of relative humidity, it is necessary to leave perimeter joints of around 10mm next to the walls and obstacles, held in place by wedges during the entire installation process. The floor should never be installed in contact with walls or other fixed construction elements.

The floor must have the capacity to expand, for example, next to thresholds, door frames, heating pipes and other types of flooring. It is also important to make sure that the baseboard covers the contraction that occurs during the winter, since a large part of the contraction affects the edges around the perimeter.

For surfaces with lengths equal to or larger than 8m, or areas larger than 40m², it is recommended to install at least one intermediate expansion joint measuring 8-10mm.

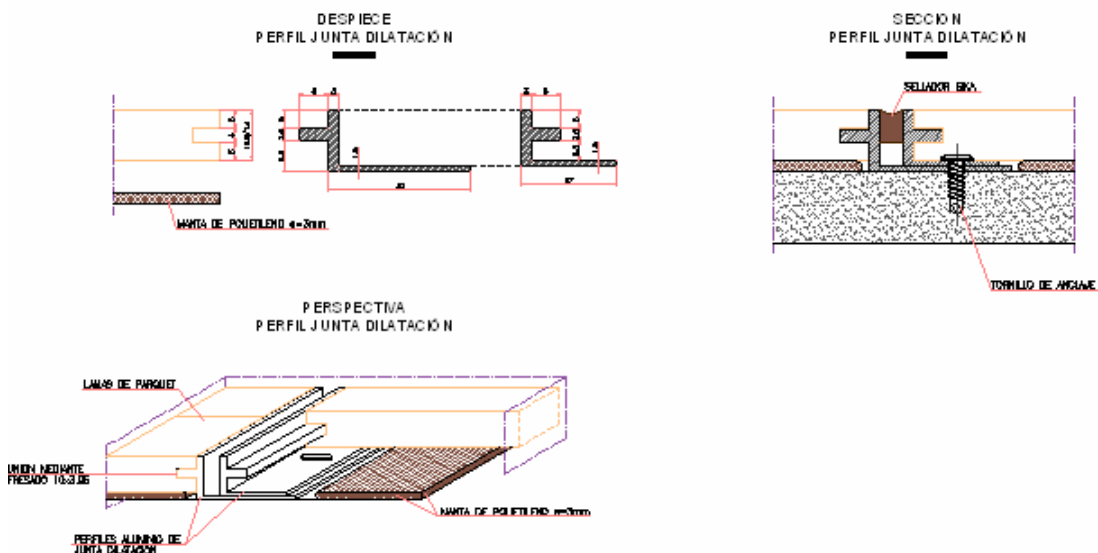

INSTALLATION OF PARKLEX 2000 AS GLUED PARQUET

The glued parquet system is recommended for wood strips >188mm wide, or when it is mandatory for the slenderness of the piece (length / width) to be less than or equal to five.

Assembly Procedure

In the event of having to use the glued system on surfaces that contain some degree of moisture or that contain water in their composition, such as mortar floors, terrazzo concrete, etc., install a polyethylene film. Over this, install 16mm waterproof MDF paneling, anchored to the flooring by screws and blocks, leaving peripheral joints of around 10mm between them, in order to absorb any possible expansion.

In the case of slenderness <5, it is mandatory to use this type of screed, regardless of the surface.

Apply continuous lines of polyurethane elastic adhesive on top of the MDF panels, leaving 30cm separations between them, transversally to the parquet.

Between the lines, place strips of insulating acoustic mat or double-sided adhesive tape in order to attain greater acoustic absorption values.

Finally, apply the parquet boards in the same manner as for a floating parquet system.